

EASY

Function

EASY lockshield valves offer the best fluid dynamic characteristics. Their tightness is ensured by an O-ring and a flat gasket placed inside the plug. All lockshield valves may be adjusted by limiting the lift of the obturator.

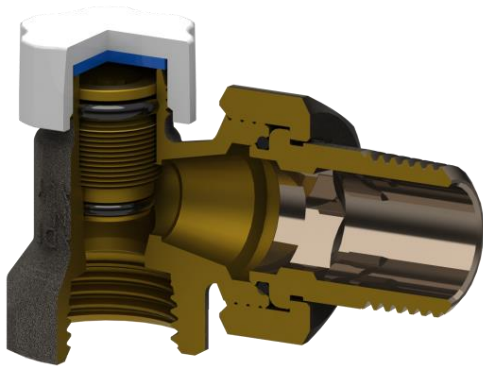

Technical data

Max. working pressure:	10 bar
Max. differential pressure:	1 bar
Max. working temperature:	120 °C
Working fluids:	Water in compliance with UNI 8065:1989

Materials

Valve body:	CW 617 N – DW UNI-EN 12165:2016
Obturator:	CW 614 N – DW UNI-EN 12164:2016
O-rings:	Peroxide cured EPDM
Flat gasket:	FASIT
Plug:	RAL9016 white ABS

Surface treatment

Nickel-plating

Dimensional Drawings

DD 121

Straight regulating lockshield.
Connection for iron pipe

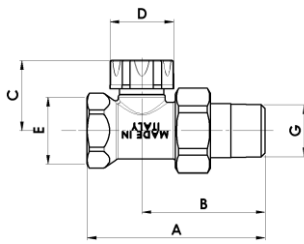

Code	Size	A	B	C	D	E
11261700	DN10 3/8	65	45	28	25	G3/8
11262100	DN15 1/2	68	47	28	25	G1/2
11262700	DN20 3/4	80	56	29	25	G3/4
Code	Size	F	G	H	L	M
11261700	DN10 3/8	-	R3/8	-	-	-
11262100	DN15 1/2	-	R1/2	-	-	-
11262700	DN20 3/4	-	R3/4	-	-	-

DS 122

Angle regulating lockshield.
Connection for iron pipe

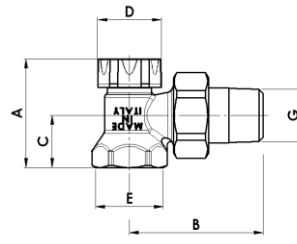

Code	Size	A	B	C	D	E
11061700	DN10 3/8	40	49	18	25	G3/8
11062100	DN15 1/2	42	51	20	25	G1/2
11062700	DN20 3/4	47	61	25	25	G3/4
Code	Size	F	G	H	L	M
11061700	DN10 3/8	-	R3/8	-	-	-
11062100	DN15 1/2	-	R1/2	-	-	-
11062700	DN20 3/4	-	R3/4	-	-	-

DD 125

Straight regulating lockshield with O-ring sealing.
Connection for iron pipe

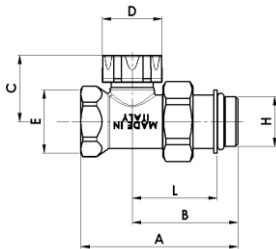

Code	Size	A	B	C	D	E
11262117	DN10 3/8	62	42	28	25	G3/8
11262103	DN15 1/2	64	43	2	25	G1/2
11262703	DN20 3/4	78	54	29	25	G3/4
Code	Size	F	G	H	L	M
11262117	DN10 3/8	-	-	G3/8	32	-
11262103	DN15 1/2	-	-	G1/2	33	-
11262703	DN20 3/4	-	-	G3/4	42	-

DS 126

Angle regulating lockshield with O-ring sealing.
Connection for iron pipe

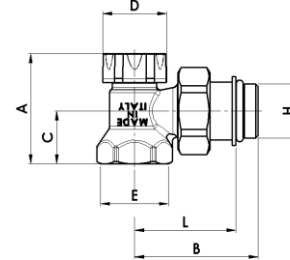

Code	Size	A	B	C	D	E
11062117	DN10 3/8	40	46	18	25	G3/8
11062103	DN15 1/2	42	47	20	25	G1/2
11062703	DN20 3/4	47	59	25	25	G3/4
Code	Size	F	G	H	L	M
11062117	DN10 3/8	-	-	G3/8	36	-
11062103	DN15 1/2	-	-	G1/2	37	-
11062703	DN20 3/4	-	-	G3/4	47	-

DD 131

Straight regulating lockshield.
Connection for copper and plastic pipe W24x19"

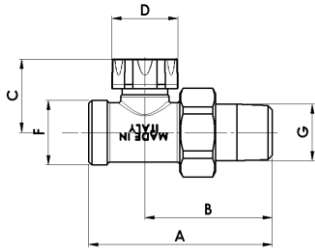

Code	Size	A	B	C	D	E
------	------	---	---	---	---	---

11361700	DN10 3/8	65	45	28	25	-
----------	----------	----	----	----	----	---

11362100	DN15 1/2	68	47	27	25	-
----------	----------	----	----	----	----	---

Code	Size	F	G	H	L	M
------	------	---	---	---	---	---

11361700	DN10 3/8	W24x19	R3/8	-	-	-
----------	----------	--------	------	---	---	---

11362100	DN15 1/2	W24x19	R1/2	-	-	-
----------	----------	--------	------	---	---	---

DS 132

Angle regulating lockshield.
Connection for copper and plastic pipe W24x19"

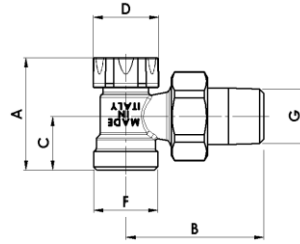

Code	Size	A	B	C	D	E
------	------	---	---	---	---	---

11161700	DN10 3/8	42	49	20	25	-
----------	----------	----	----	----	----	---

11162100	DN15 1/2	42	51	20	25	-
----------	----------	----	----	----	----	---

Code	Size	F	G	H	L	M
------	------	---	---	---	---	---

11161700	DN10 3/8	W24x19	R3/8	-	-	-
----------	----------	--------	------	---	---	---

11162100	DN15 1/2	W24x19	R1/2	-	-	-
----------	----------	--------	------	---	---	---

DD 138

Straight regulating lockshield with O-ring sealing.
Connection for copper and plastic pipe W24x19"

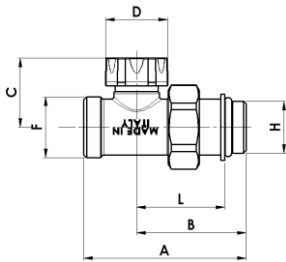

Code	Size	A	B	C	D	E
------	------	---	---	---	---	---

11362117	DN10 3/8	63	42	28	25	-
----------	----------	----	----	----	----	---

11362103	DN15 1/2	64	43	27	25	-
----------	----------	----	----	----	----	---

Code	Size	F	G	H	L	M
------	------	---	---	---	---	---

11362117	DN10 3/8	W24x19	-	G3/8	32	-
----------	----------	--------	---	------	----	---

11362103	DN15 1/2	W24x19	-	G1/2	33	-
----------	----------	--------	---	------	----	---

DS 139

Angle regulating lockshield with O-ring sealing.
Connection for copper and plastic pipe W24x19"

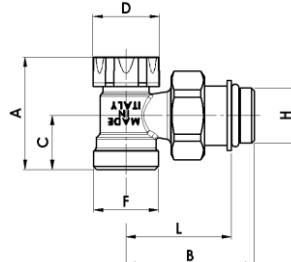

Code	Size	A	B	C	D	E
------	------	---	---	---	---	---

11162117	DN10 3/8	42	46	20	25	-
----------	----------	----	----	----	----	---

11162103	DN15 1/2	42	47	20	25	-
----------	----------	----	----	----	----	---

Code	Size	F	G	H	L	M
------	------	---	---	---	---	---

11162117	DN10 3/8	W24x19	-	G3/8	36	-
----------	----------	--------	---	------	----	---

11162103	DN15 1/2	W24x19	-	G1/2	37	-
----------	----------	--------	---	------	----	---

DD 131/A

Straight regulating lockshield.
Connection for copper and plastic pipe G3/4 Eurokonus

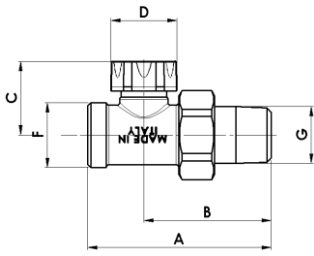

Code	Size	A	B	C	D	E
11362719	DN10 3/8	66	45	28	25	-
11362722	DN15 1/2	69	48	28	25	-

Code	Size	F	G	H	L	M
11362719	DN10 3/8	G3/4EK	R3/8	-	-	-
11362722	DN15 1/2	G3/4EK	R1/2	-	-	-

DS 132/A

Angle regulating lockshield.
Connection for copper and plastic pipe G3/4 Eurokonus

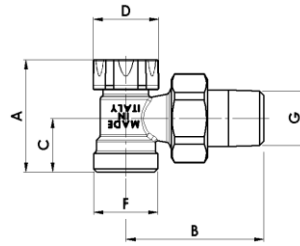

Code	Size	A	B	C	D	E
11162718	DN10 3/8	42	49	20	25	-
11162721	DN15 1/2	42	51	20	25	-

Code	Size	F	G	H	L	M
11162718	DN10 3/8	G3/4EK	R3/8	-	-	-
11162721	DN15 1/2	G3/4EK	R1/2	-	-	-

DD 138/A

Straight regulating lockshield with O-ring sealing.
Connection for copper and plastic pipe G3/4 Eurokonus

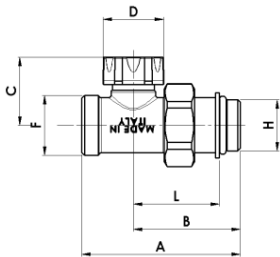

Code	Size	A	B	C	D	E
11362717	DN10 3/8	63	42	28	25	-
11362703	DN15 1/2	64	43	27	25	-

Code	Size	F	G	H	L	M
11362717	DN10 3/8	G3/4EK	-	G3/8	32	-
11362703	DN15 1/2	G3/4EK	-	G1/2	33	-

DS 139/A

Angle regulating lockshield with O-ring sealing.
Connection for copper and plastic pipe G3/4 Eurokonus

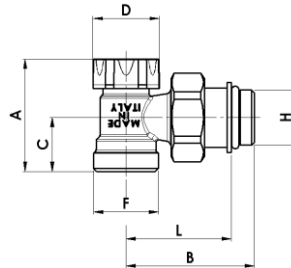

Code	Size	A	B	C	D	E
11162717	DN10 3/8	42	46	20	25	-
11162703	DN15 1/2	42	47	20	25	-

Code	Size	F	G	H	L	M
11162717	DN10 3/8	G3/4EK	-	G3/8	36	-
11162703	DN15 1/2	G3/4EK	-	G1/2	37	-

Hydraulic Characteristics

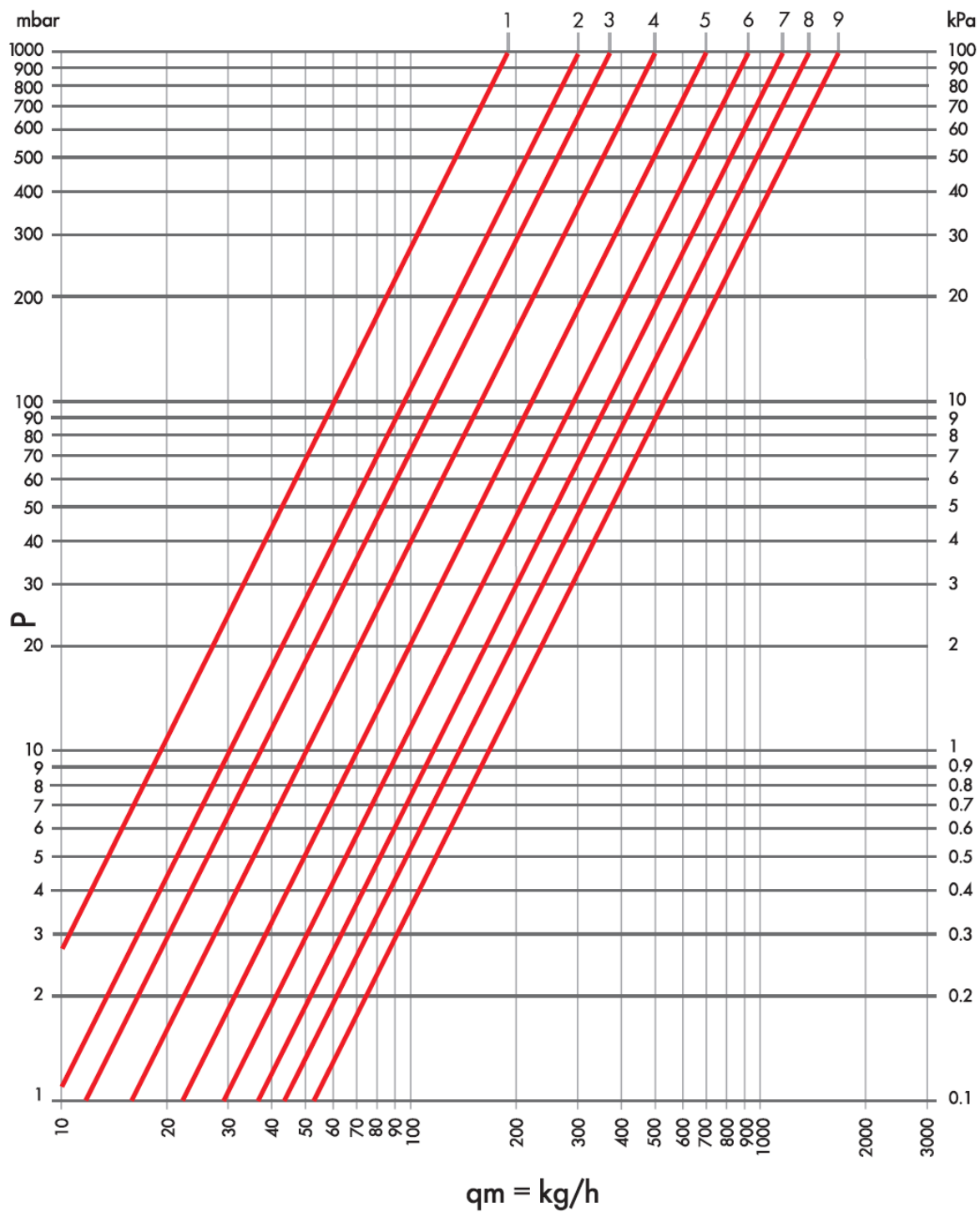

Pos.	Turns	Kv	Items
1	1	0.19	
2	1+1/2	0.30	
3	2	0.37	
4	2+1/2	0.50	
5	3	0.69	DS 122 3/8; DS 122 1/2; DS 126 3/8; DS 126 1/2; DS 132 3/8; DS 132 1/2;
6	3+1/2	0.92	DS 139 3/8; DS 139 1/2; DS 132/A 3/8; DS 132/A 1/2; DS 139/A 3/8; DS 139/A 1/2.
7	4	1.14	
8	4+1/2	1.39	
9	All open	1.65	

Hydraulic Characteristics

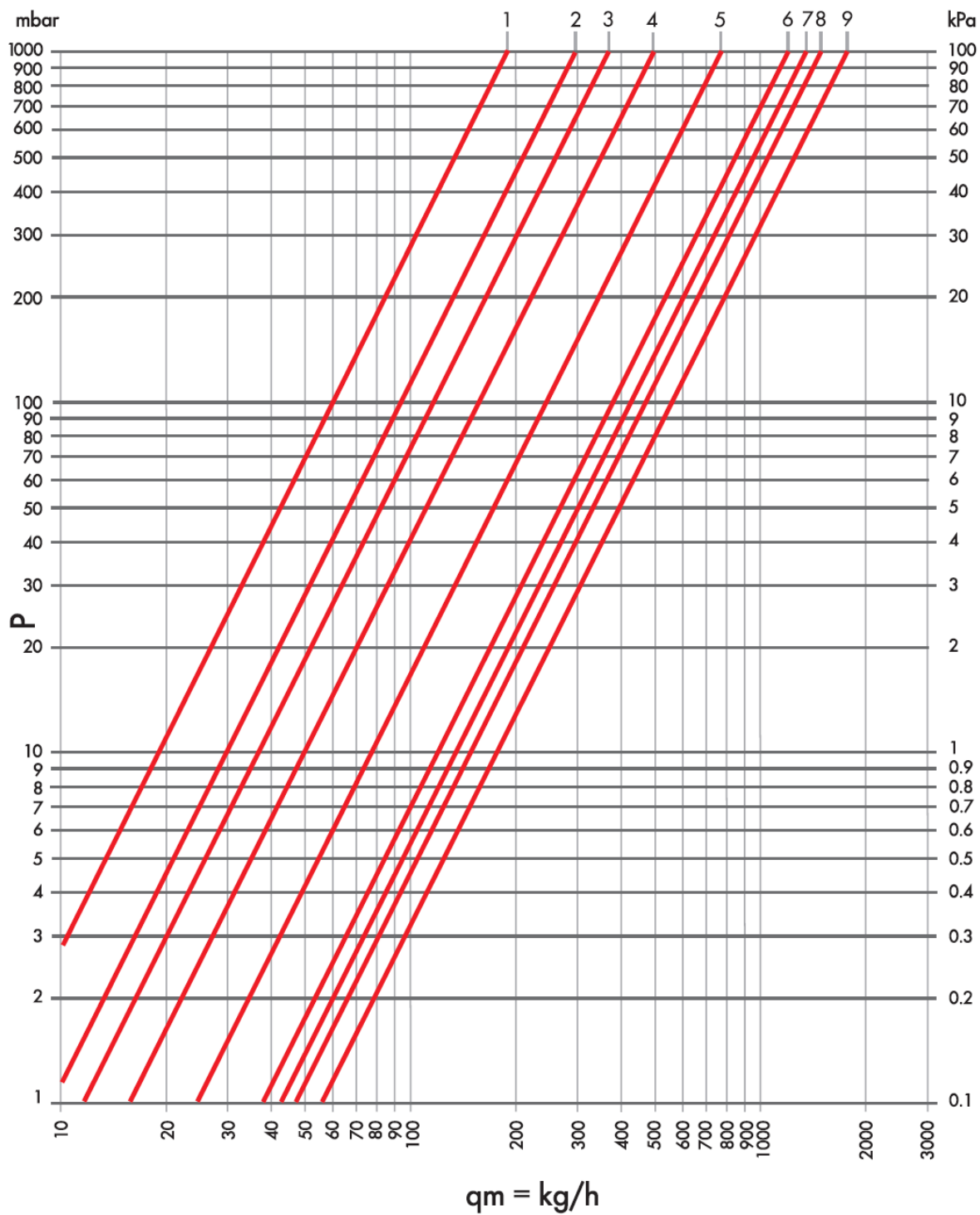

Pos.	Turns	Kv	Items
1	1	0.19	
2	1+1/2	0.30	
3	2	0.37	
4	2+1/2	0.50	
5	3	0.78	DS 122 3/4; DS 126 3/4.
6	3+1/2	1.19	
7	4	1.34	
8	4+1/2	1.50	
9	All open	1.75	

Hydraulic Characteristics

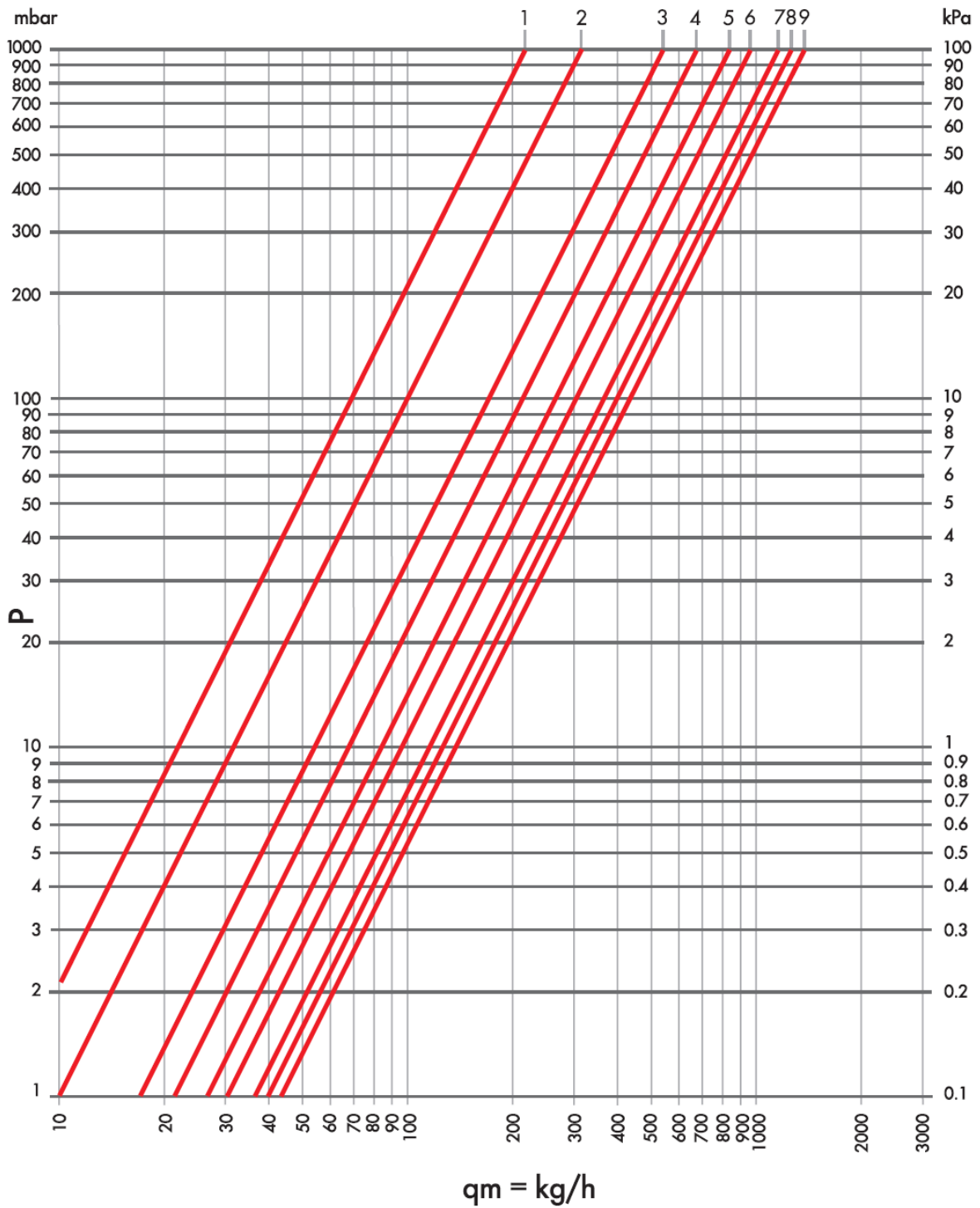

Pos.	Turns	Kv	Items
1	1	0.22	
2	1+1/2	0.32	
3	2	0.53	
4	2+1/2	0.68	
5	3	0.84	DD 121 3/8; DD 121 1/2; DD 125 3/8; DD 125 1/2; DD 131 3/8; DD 131 1/2;
6	3+1/2	0.97	DD 138 3/8; DD 138 1/2; DD 131/A 3/8; DD 131/A 1/2; DD 138/A 3/8; DD 138/A 1/2.
7	4	1.14	
8	4+1/2	1.25	
9	All open	1.34	

Hydraulic Characteristics

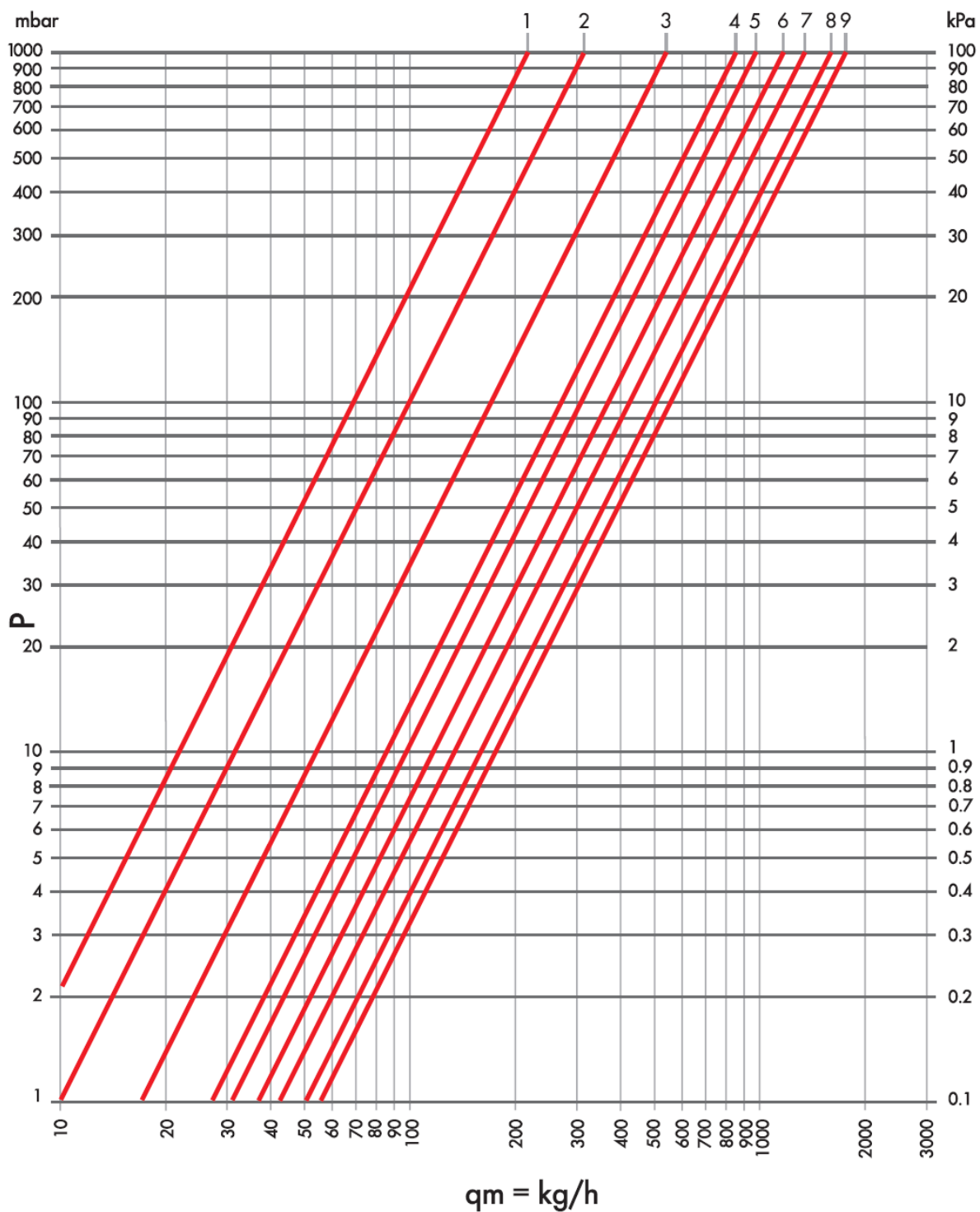

Pos.	Turns	Kv	Items
1	1	0.22	
2	1+1/2	0.32	
3	2	0.54	
4	2+1/2	0.85	
5	3	0.97	DD 121 3/4; DD 125 3/4.
6	3+1/2	1.19	
7	4	1.34	
8	4+1/2	1.60	
9	All open	1.75	

Working Instructions

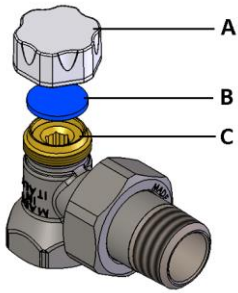

- To adjust the flow rate:
 - Unscrew the ABS plug “A”;
 - Without forcing, use a 6 mm Allen key to close the obturator “C”;
 - Open the obturator for a number of turns as indicated on the flow rate diagram
 - Screw back the ABS plug “A” taking care of inserting the FASIT flat gasket “B” into it.
- **WARNING:** Once the system has been leak tested, please relieve the pressure. A differential pressure over 1 bar between the inlet and the outlet of the valve may cause the sealing O-ring to be expelled.

Item Specifications

DD 121

Straight regulating lockshield valve with ABS sealing plug. ISO 228/1 connection for iron pipe 3/8"F, 1/2"F and 3/4"F. Radiator connection with prefitted peroxide cured EPDM O-ring and DIN 2999 conical thread 3/8"M, 1/2"M and 3/4"M. Valve body in nickel-plated brass. The tightness towards the outside is ensured by a peroxide cured EPDM O-ring and a FASIT flat gasket placed inside the plug. When in closed position, the tightness is granted by a peroxide cured EPDM O-ring. Max. working temp. 120 °C, max. working pressure 10 bar, differential pressure 1 bar.

DS 122

Angle regulating lockshield valve with ABS sealing plug. ISO 228/1 connection for iron pipe 3/8"F, 1/2"F and 3/4"F. Radiator connection with prefitted peroxide cured EPDM O-ring and DIN 2999 conical thread 3/8"M, 1/2"M and 3/4"M. Valve body in nickel-plated brass. The tightness towards the outside is ensured by a peroxide cured EPDM O-ring and a FASIT flat gasket placed inside the plug. When in closed position, the tightness is granted by a peroxide cured EPDM O-ring. Max. working temp. 120 °C, max. working pressure 10 bar, differential pressure 1 bar.

DD 125

Straight regulating lockshield valve with ABS sealing plug. ISO 228/1 connection for iron pipe 3/8"F, 1/2"F and 3/4"F. Radiator connection with prefitted peroxide cured EPDM O-ring and DIN 2999 conical thread 3/8"M and 1/2"M. Valve body in nickel-plated brass. The tightness towards the outside is ensured by a peroxide cured EPDM O-ring and a FASIT flat gasket placed inside the plug. When in closed position, the tightness is granted by a peroxide cured EPDM O-ring. Max. working temp. 120 °C, max. working pressure 10 bar, differential pressure 1 bar.

DS 126

Angle regulating lockshield valve with ABS sealing plug. ISO 228/1 connection for iron pipe 3/8"F, 1/2"F and 3/4"F. Radiator connection with prefitted peroxide cured EPDM O-ring and DIN 2999 conical thread 3/8"M and 1/2"M. Valve body in nickel-plated brass. The tightness towards the outside is ensured by a peroxide cured EPDM O-ring and a FASIT flat gasket placed inside the plug. When in closed position, the tightness is granted by a peroxide cured EPDM O-ring. Max. working temp. 120 °C, max. working pressure 10 bar, differential pressure 1 bar.

DD 131

Straight regulating lockshield valve with ABS sealing plug. W24x19 connection for copper, plastic and multilayer pipe. Radiator connection with prefitted peroxide cured EPDM O-ring and DIN 2999 conical thread 3/8"M and 1/2"M. Valve body in nickel-plated brass. The tightness towards the outside is ensured by a peroxide cured EPDM O-ring and a FASIT flat gasket placed inside the plug. When in closed position, the tightness is granted by a peroxide cured EPDM O-ring. Max. working temp. 120 °C, max. working pressure 10 bar, differential pressure 1 bar.

DS 132

Straight regulating lockshield valve with ABS sealing plug. W24x19 connection for copper, plastic and multilayer pipe. Radiator connection with prefitted peroxide cured EPDM O-ring and DIN 2999 conical thread 3/8"M and 1/2"M. Valve body in nickel-plated brass. The tightness towards the outside is ensured by a peroxide cured EPDM O-ring and a FASIT flat gasket placed inside the plug. When in closed position, the tightness is granted by a peroxide cured EPDM O-ring. Max. working temp. 120 °C, max. working pressure 10 bar, differential pressure 1 bar.

DD 138

Straight regulating lockshield valve with ABS sealing plug. W24x19 connection for copper, plastic and multilayer pipe. 3/8"M and 1/2"M radiator connection with prefitted peroxide cured EPDM O-ring, cylindrical thread and O-ring towards the radiator. Valve body in nickel-plated brass. The tightness towards the outside is ensured by a peroxide cured EPDM O-ring and a FASIT flat gasket placed inside the plug. When in closed position, the tightness is granted by a peroxide cured EPDM O-ring. Max. working temp. 120 °C, max. working pressure 10 bar, differential pressure 1 bar.

DS 139

Straight regulating lockshield valve with ABS sealing plug. W24x19 connection for copper, plastic and multilayer pipe. 3/8"M and 1/2"M radiator connection with prefitted peroxide cured EPDM O-ring, cylindrical thread and O-ring towards the radiator. Valve body in nickel-plated brass. The tightness towards the outside is ensured by a peroxide cured EPDM O-ring and a FASIT flat gasket placed inside the plug. When in closed position, the tightness is granted by a peroxide cured EPDM O-ring. Max. working temp. 120 °C, max. working pressure 10 bar, differential pressure 1 bar.

DD 131/A

Straight regulating lockshield valve with ABS sealing plug. 3/4"M EK connection for copper, plastic and multilayer pipe. 3/8"M and 1/2"M radiator connection with prefitted peroxide cured EPDM O-ring, DIN 2999 conical thread. Valve body in nickel-plated brass. The tightness towards the outside is ensured by a peroxide cured EPDM O-ring and a FASIT flat gasket placed inside the plug. When in closed position, the tightness is granted by a peroxide cured EPDM O-ring. Max. working temp. 120 °C, max. working pressure 10 bar, differential pressure 1 bar.

DS 132/A

Angle regulating lockshield valve with ABS sealing plug. 3/4"M EK connection for copper, plastic and multilayer pipe. 3/8"M and

1/2" radiator connection with prefitted peroxide cured EPDM O-ring, DIN 2999 conical thread. Valve body in nickel-plated brass. The tightness towards the outside is ensured by a peroxide cured EPDM O-ring and a FASIT flat gasket placed inside the plug. When in closed position, the tightness is granted by a peroxide cured EPDM O-ring. Max. working temp. 120 °C, max. working pressure 10 bar, differential pressure 1 bar.

DD 138/A

Straight regulating lockshield valve with ABS sealing plug. 3/4" EK connection for copper, plastic and multilayer pipe. 3/8" and 1/2" radiator connection with prefitted peroxide cured EPDM O-ring, cylindrical thread and O-ring towards the radiator. Valve body in nickel-plated brass. The tightness towards the outside is ensured by a peroxide cured EPDM O-ring and a FASIT flat gasket placed inside the plug. When in closed position, the tightness is granted by a peroxide cured EPDM O-ring. Max. working temp. 120 °C, max. working pressure 10 bar, differential pressure 1 bar.

DS 139/A

Angle regulating lockshield valve with ABS sealing plug. 3/4" EK connection for copper, plastic and multilayer pipe. 3/8" and 1/2" radiator connection with prefitted peroxide cured EPDM O-ring, cylindrical thread and O-ring towards the radiator. Valve body in nickel-plated brass. The tightness towards the outside is ensured by a peroxide cured EPDM O-ring and a FASIT flat gasket placed inside the plug. When in closed position, the tightness is granted by a peroxide cured EPDM O-ring. Max. working temp. 120 °C, max. working pressure 10 bar, differential pressure 1 bar.



Luxor S.p.A.

Sede amministrativa, stabilimento e uffici commerciali:

Administrative office, factory and commercial office:

Tel.: 030-9961161 – Fax: 030-9961165

info@luxor.it – www.luxor.it

via Madonnina, 94 – 25018 Montichiari - (BS)

*Luxor si riserva il diritto di apportare miglioramenti e modifiche ai prodotti descritti ed ai relativi dati tecnici in qualsiasi momento e senza preavviso
Luxor reserves the right to ameliorate and modify the products described above and their technical data at any time and without notice*